

Notes:

- CONTRACTOR AND SUB-TRADES SHALL VERIFY ALL SITE DIMENSIONS. ALL DRAWINGS, DETAILS AND SPECIFICATIONS AND REPORT ANY DISCREPANCIES TO THE INTERIOR DESIGNER IN WRITING FOR APPROVAL BEFORE PROCEEDING WITH THE WORK.
- CONTRACTOR AND SUB-CONTRACTORS, BEFORE PROCEEDING WITH WORK, MUST SUBMIT ALL NECESSARY SAMPLES FOR APPROVAL OF QUALITY AND FINISH TO THE INTERIOR DESIGNER.
- CONTRACTOR MUST COMPLY WITH THE CONTRACT DOCUMENTS, PERFORMANCE REQUIREMENTS, APPLICABLE CODES AND REGULATIONS.
- ALL DRAWINGS AND WRITTEN MATERIAL HEREIN CONSTITUTE THE ORIGINAL AND UNPUBLISHED WORK OF "IBY DESIGN ASSOCIATES INC." AND MAY NOT BE DUPLICATED, USED OR DISCLOSED WITHOUT PRIOR WRITTEN CONSENT OF "IBY DESIGN ASSOCIATES INC."
- DRAWINGS NOT TO BE SCALED

Issue:

08 ISSUED FOR CLIENT REVIEW	16.01.15
07 ISSUED FOR TENDER	16.03.15
08 ISSUED FOR ADDENDUM	16.09.20
10 ISSUED FOR CONSTRUCTION	17.06.19
13 SITE INSTRUCTION #03	17.11.10
14 SITE INSTRUCTION #04	18.03.07
17 SITE INSTRUCTION #07	18.05.31
-	-
-	-
-	-
-	-
-	-

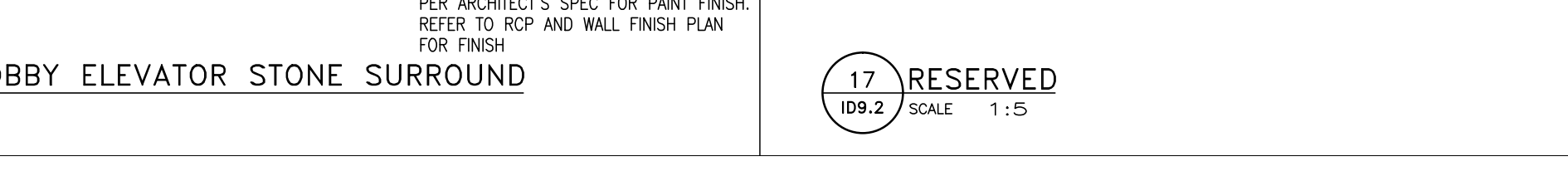
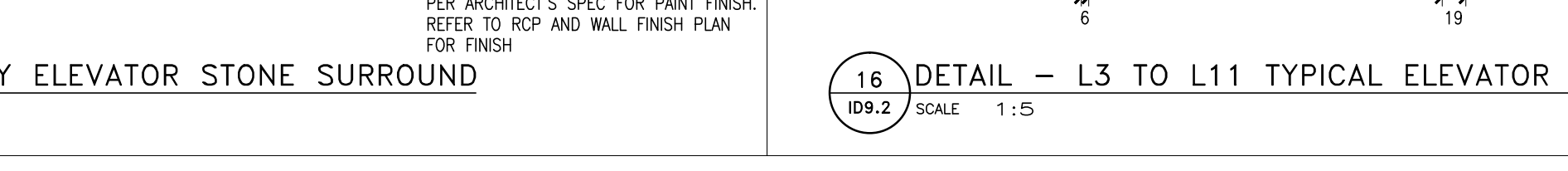
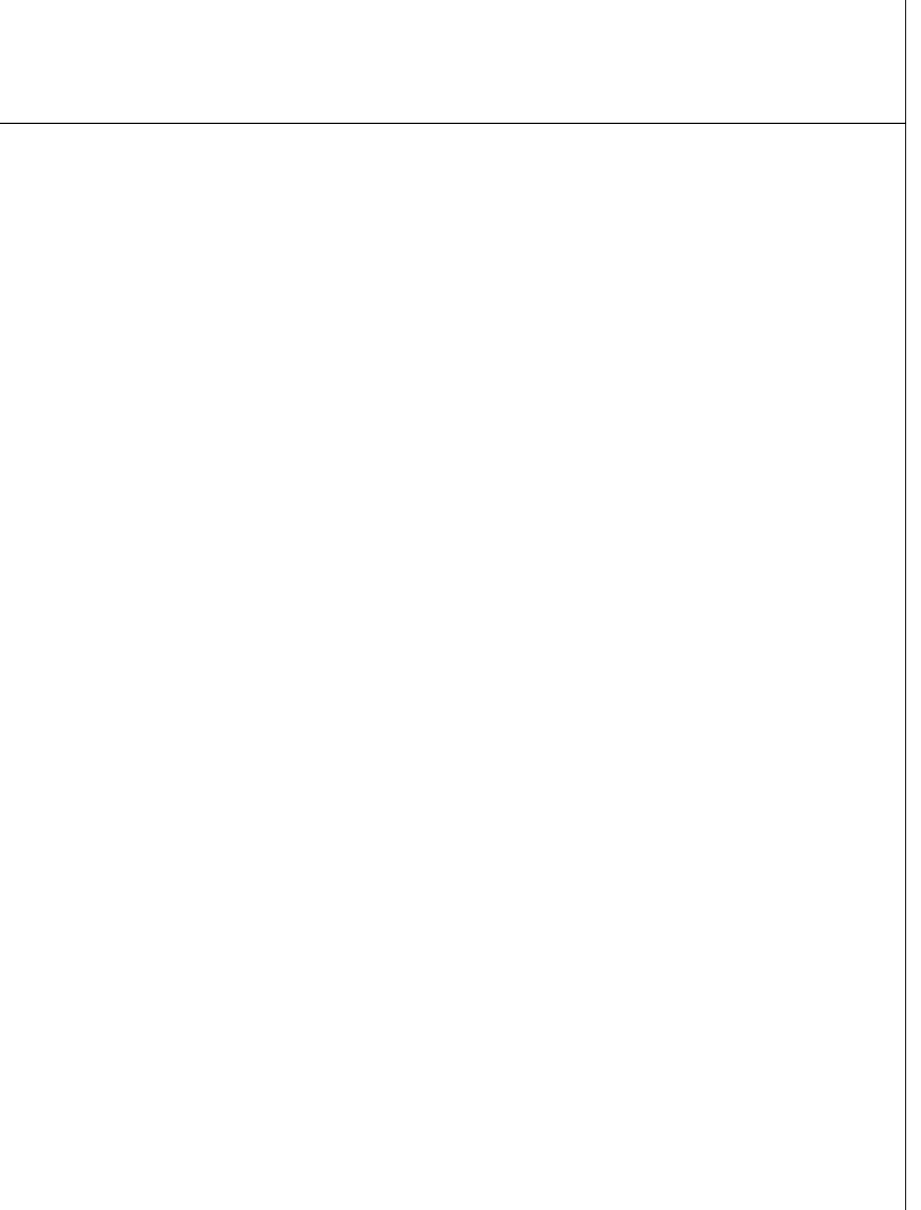
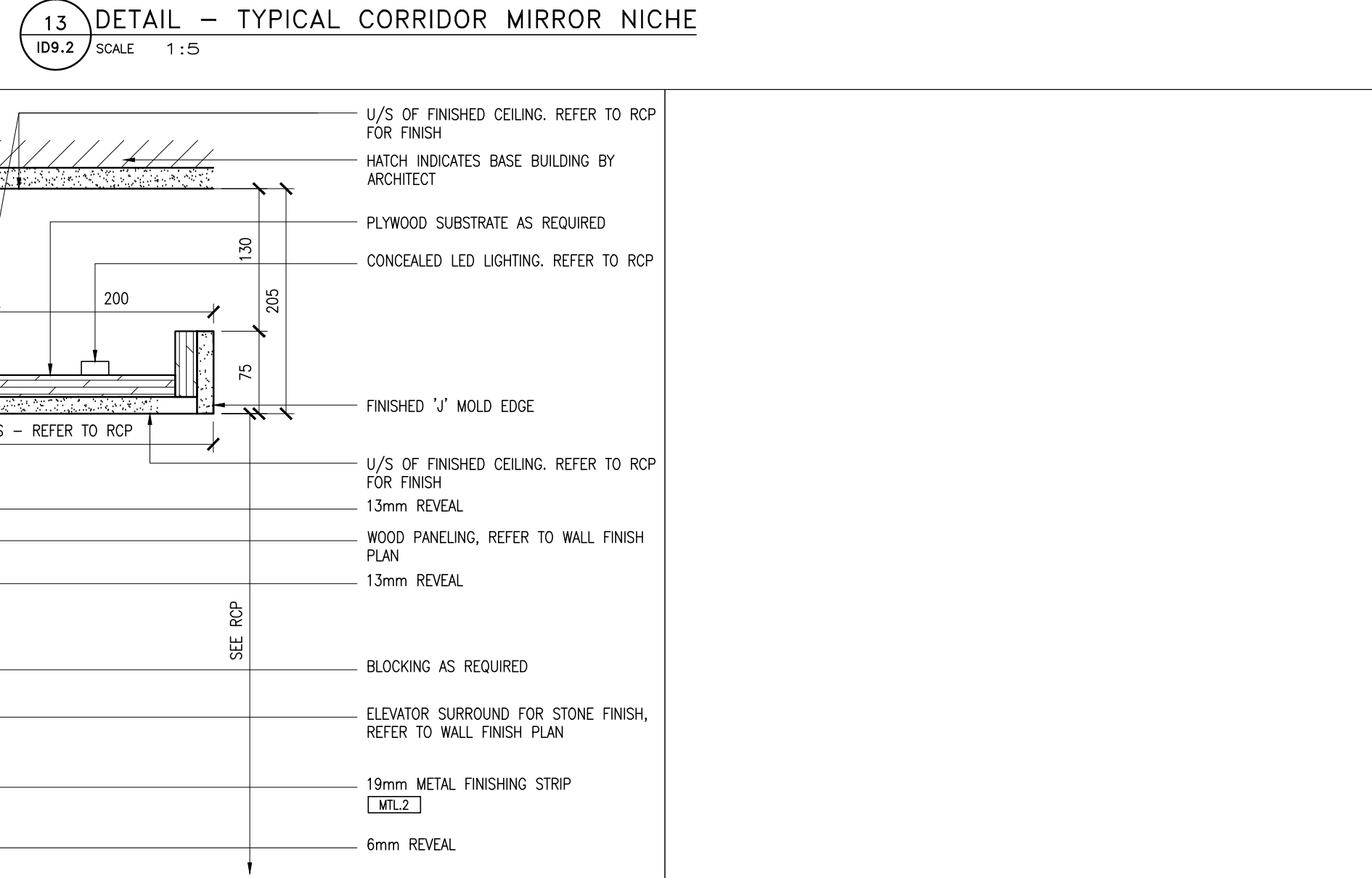
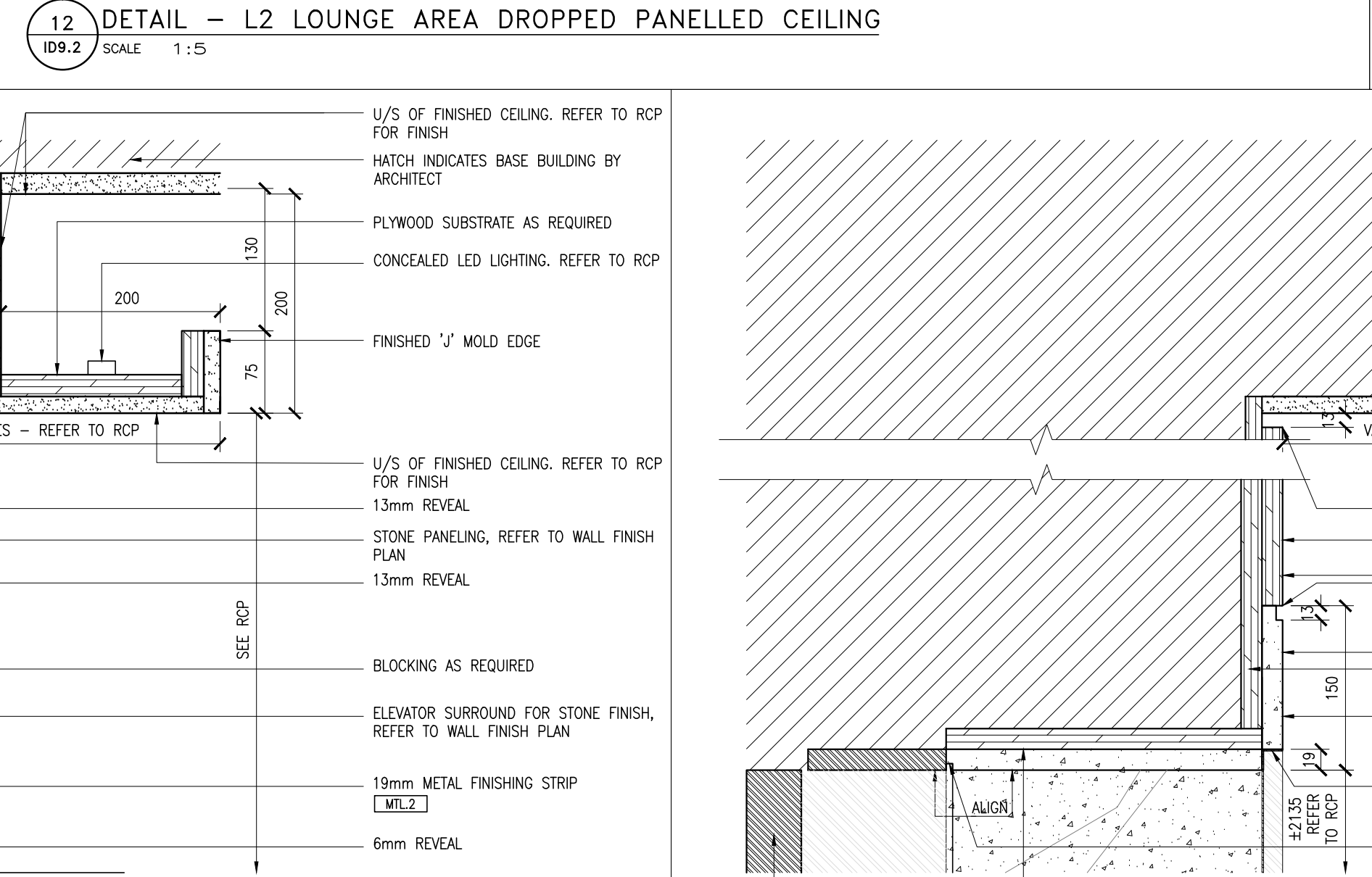
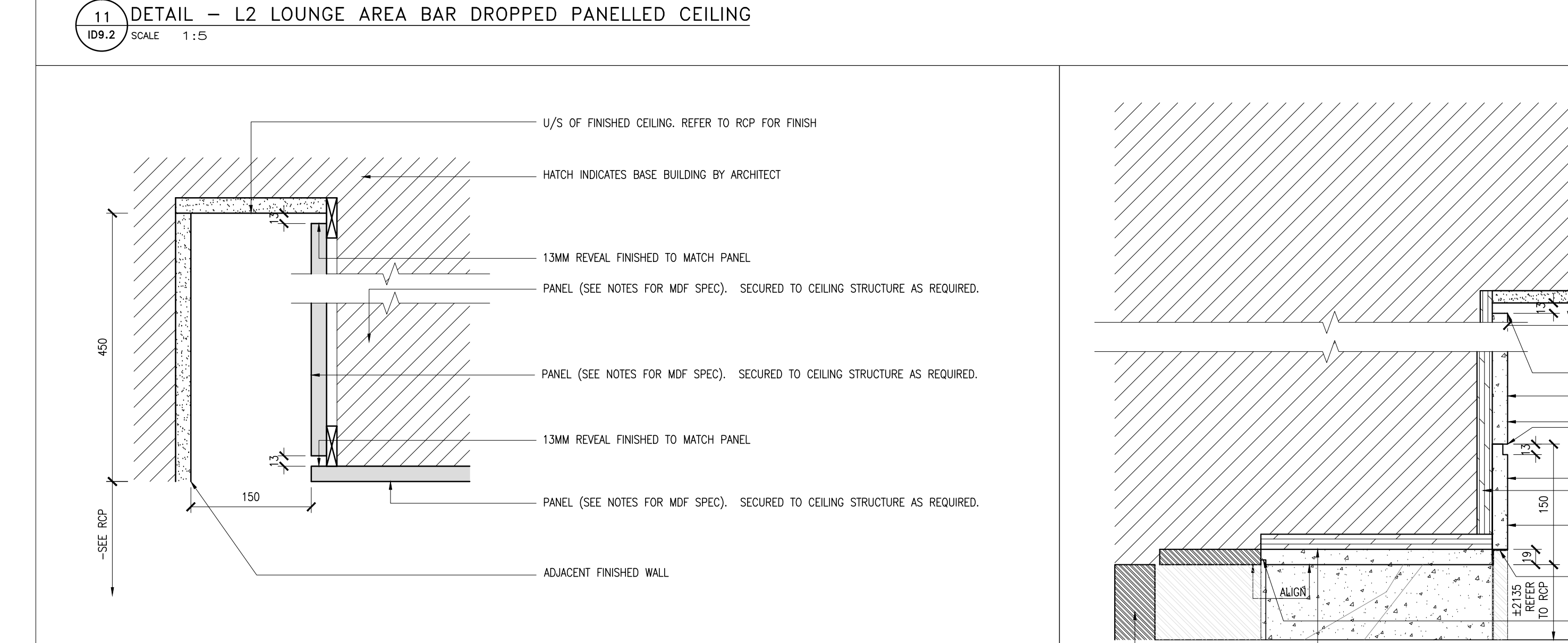
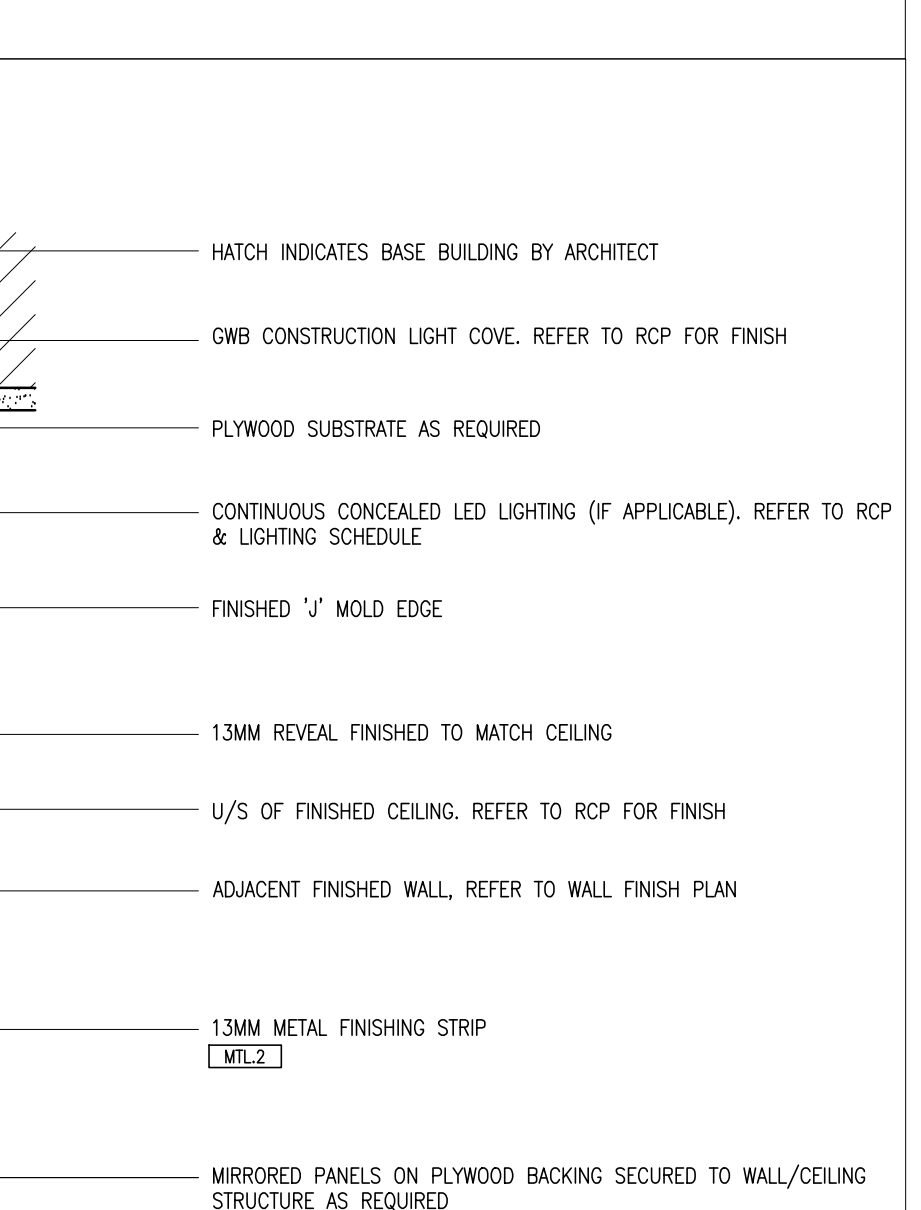
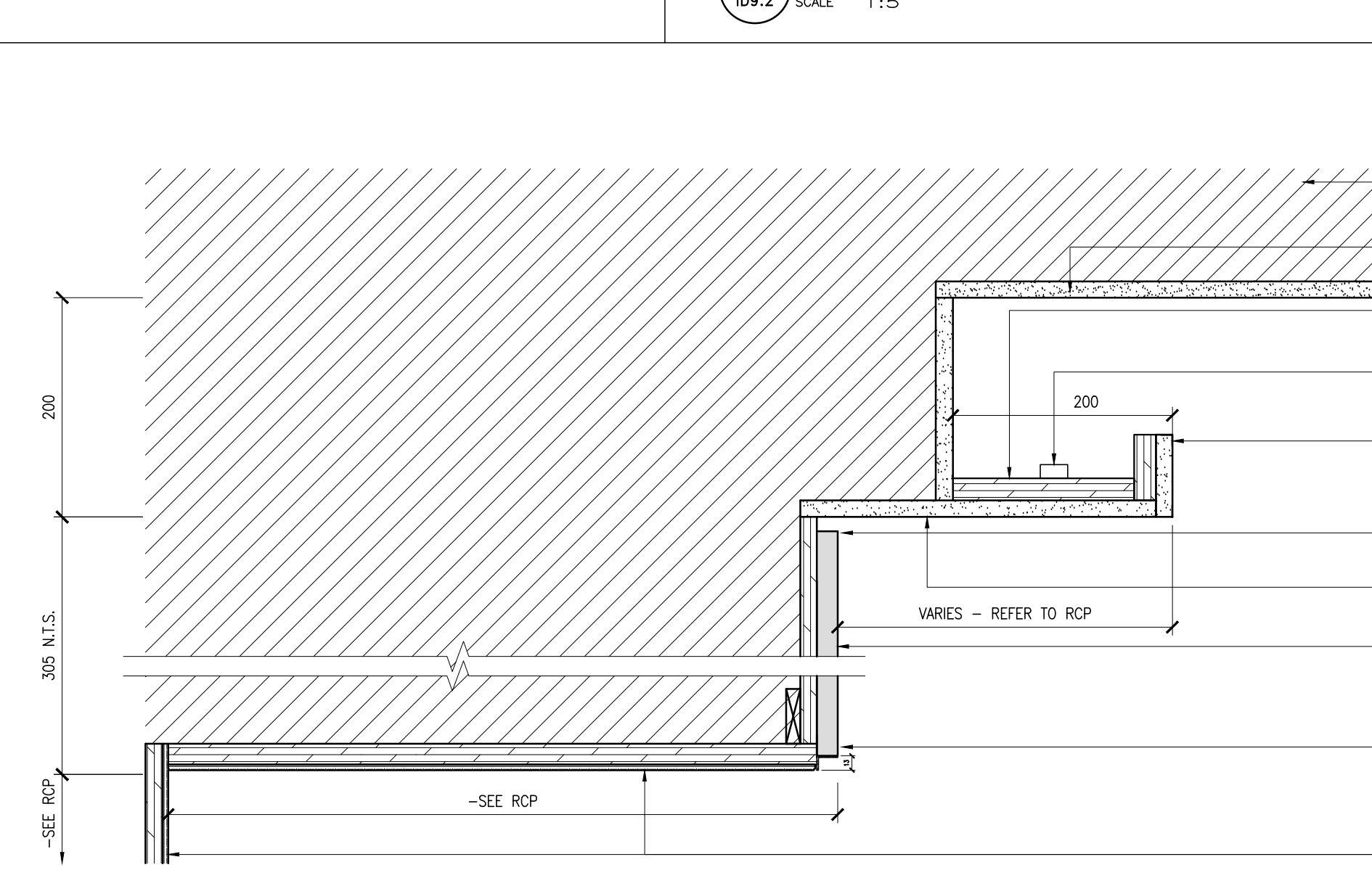
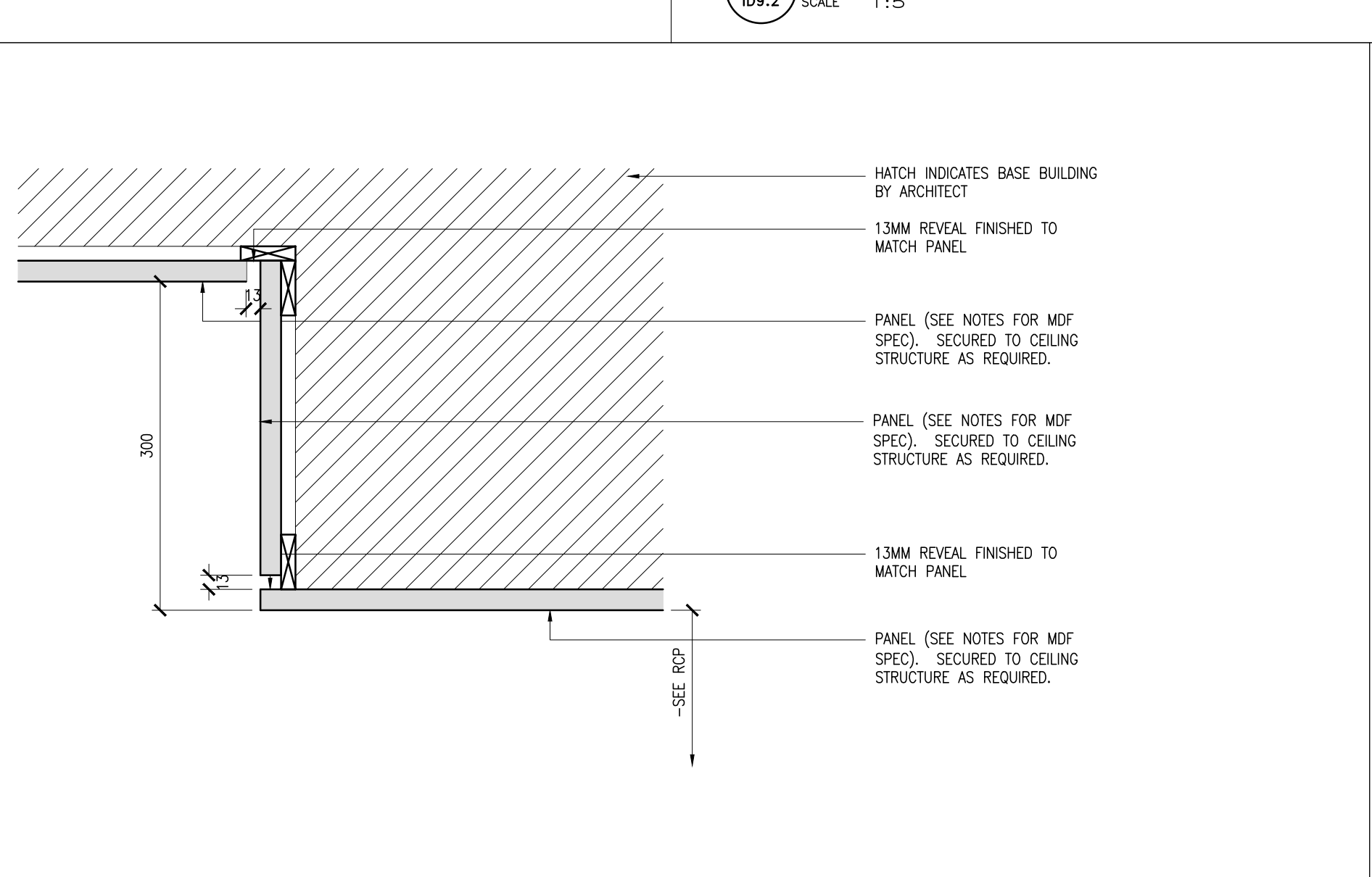
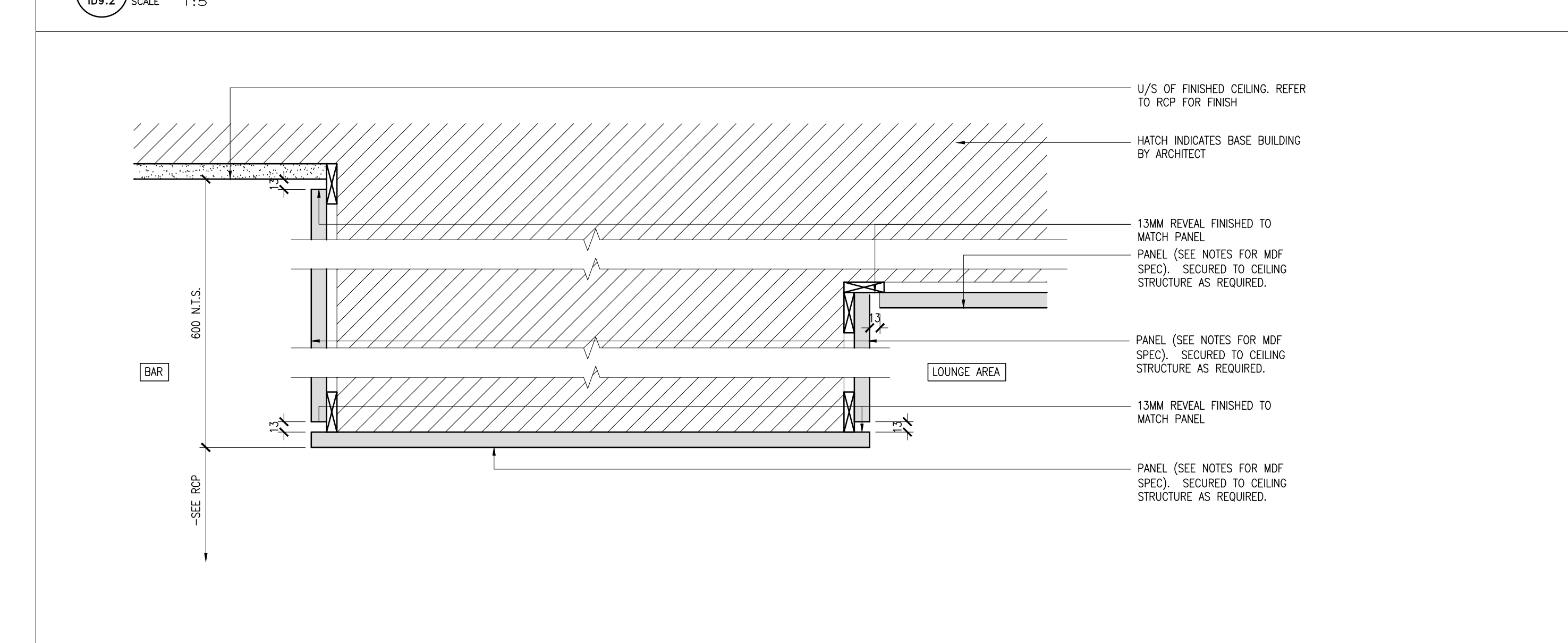
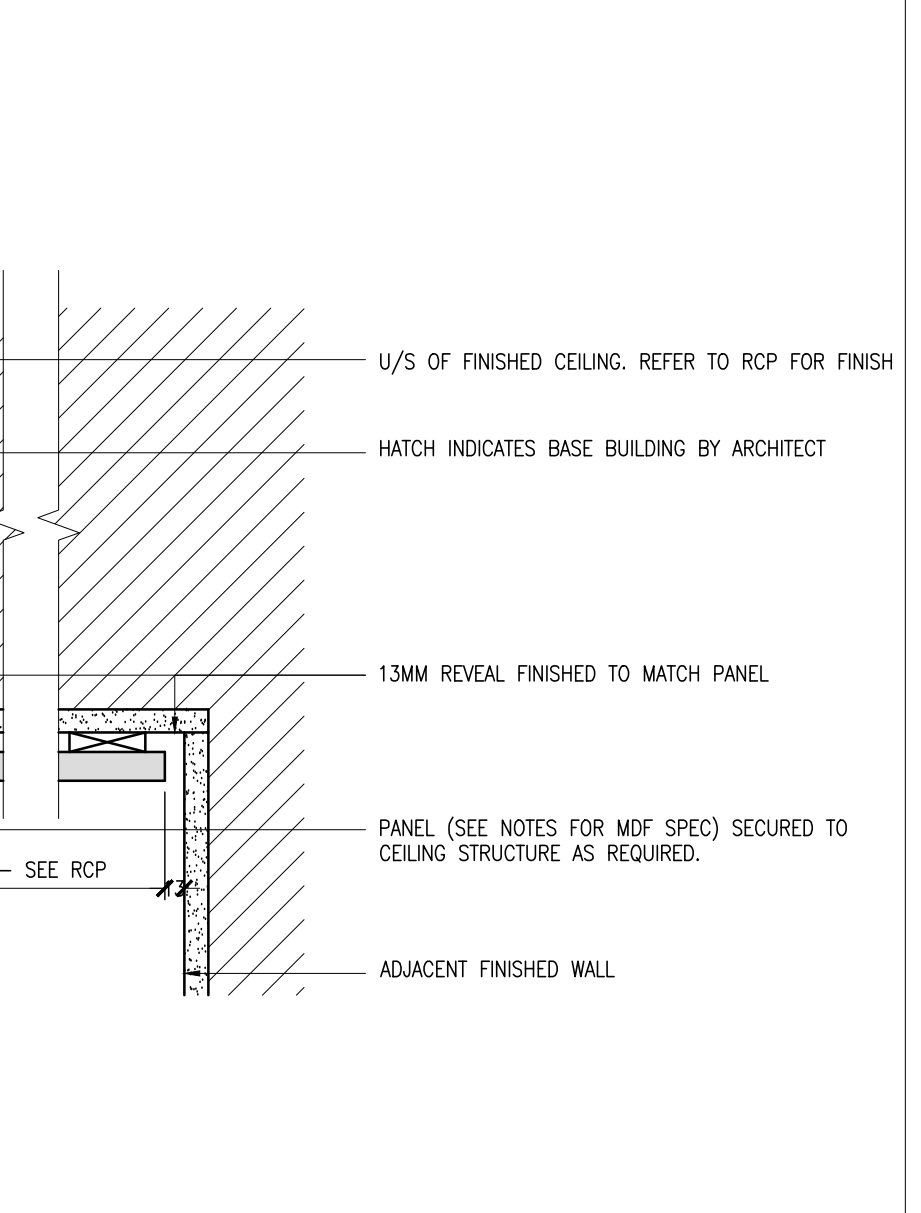
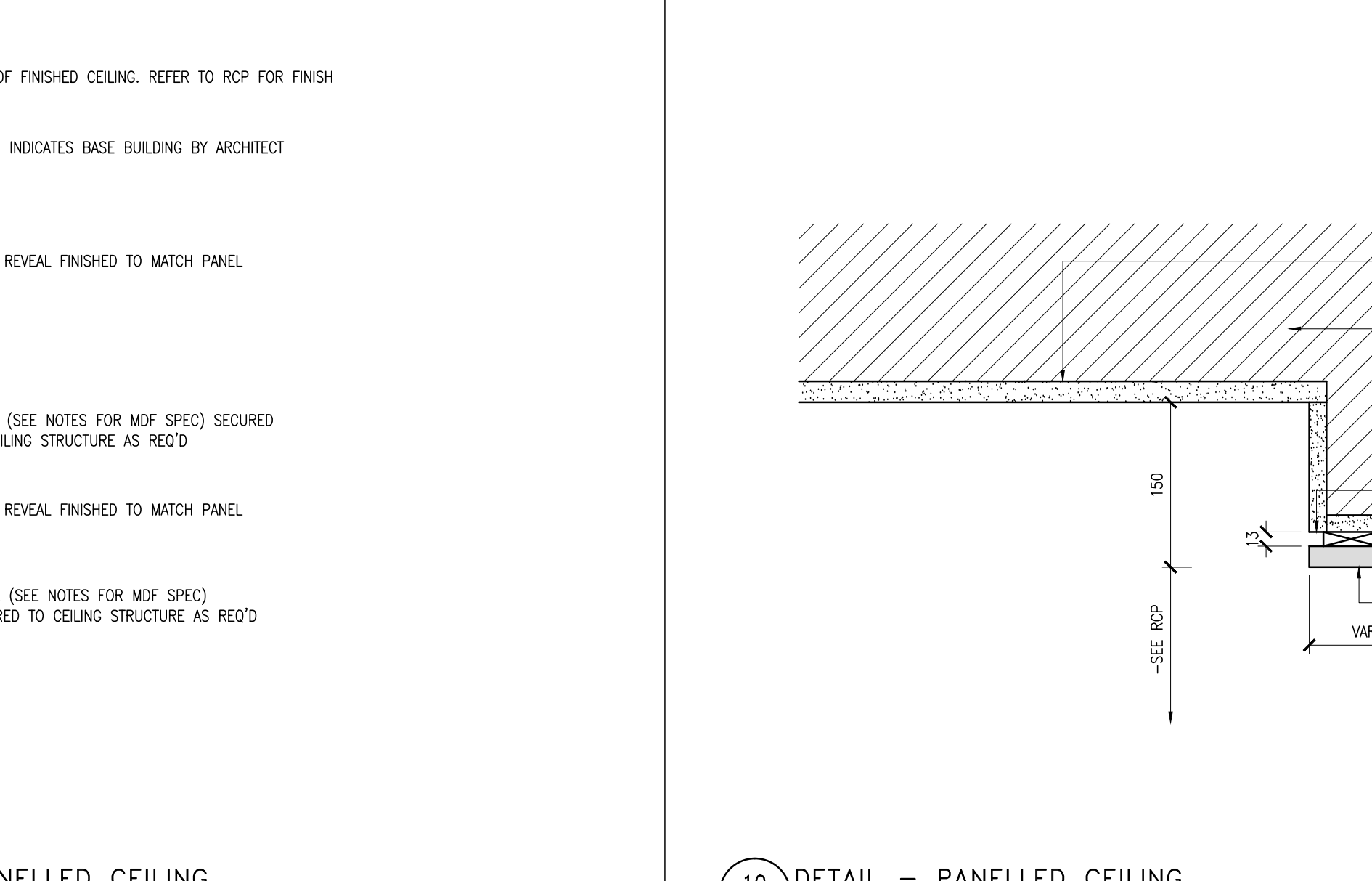
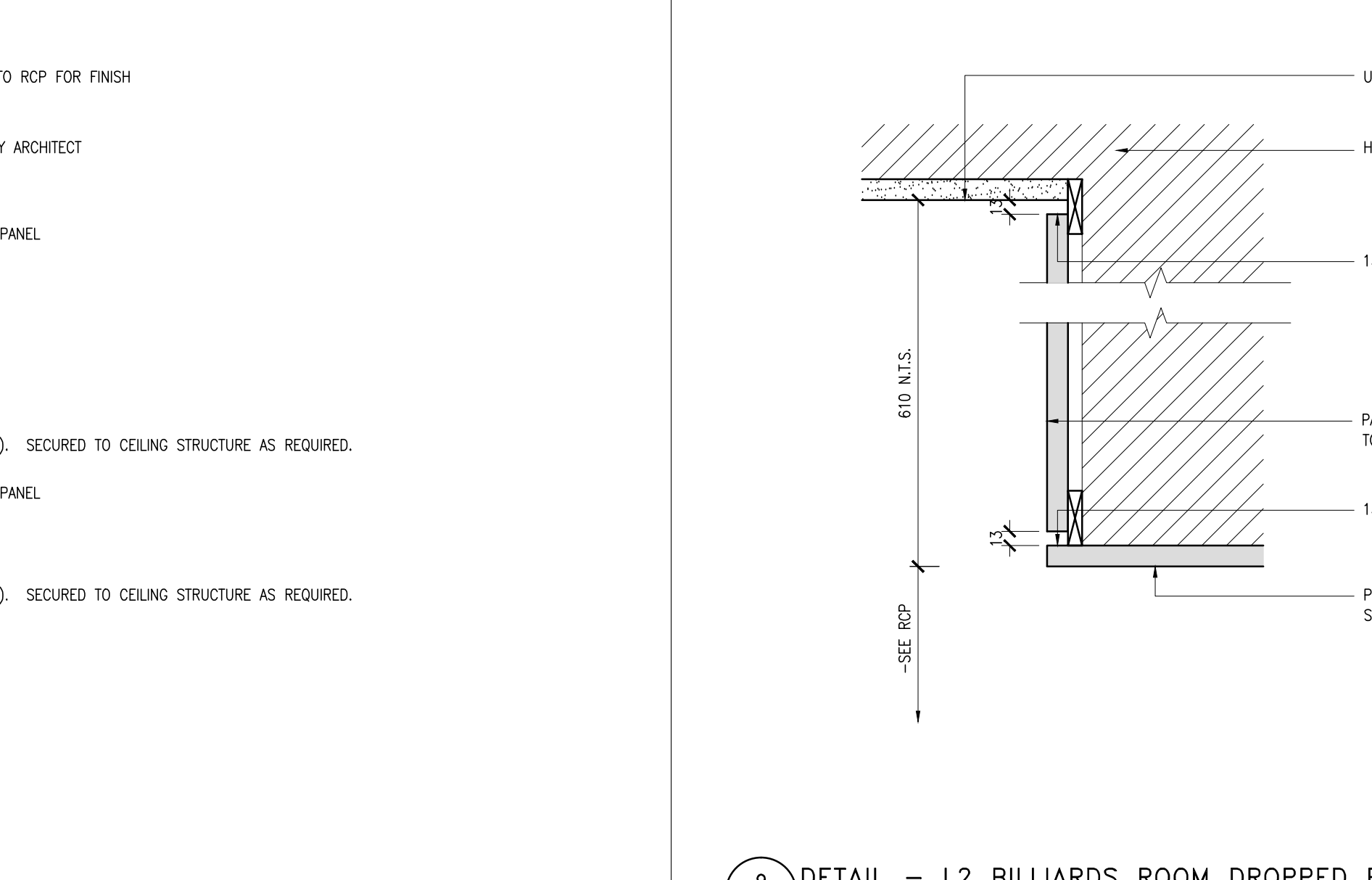
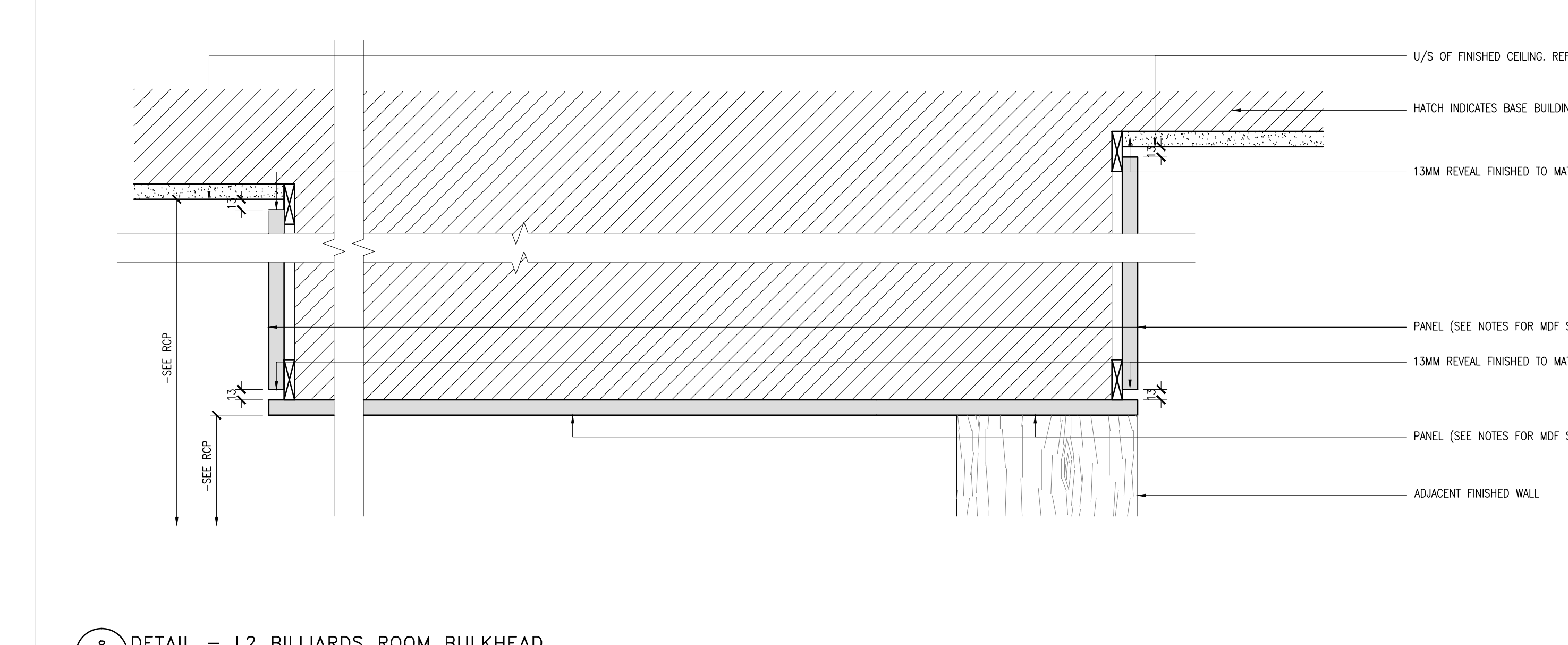
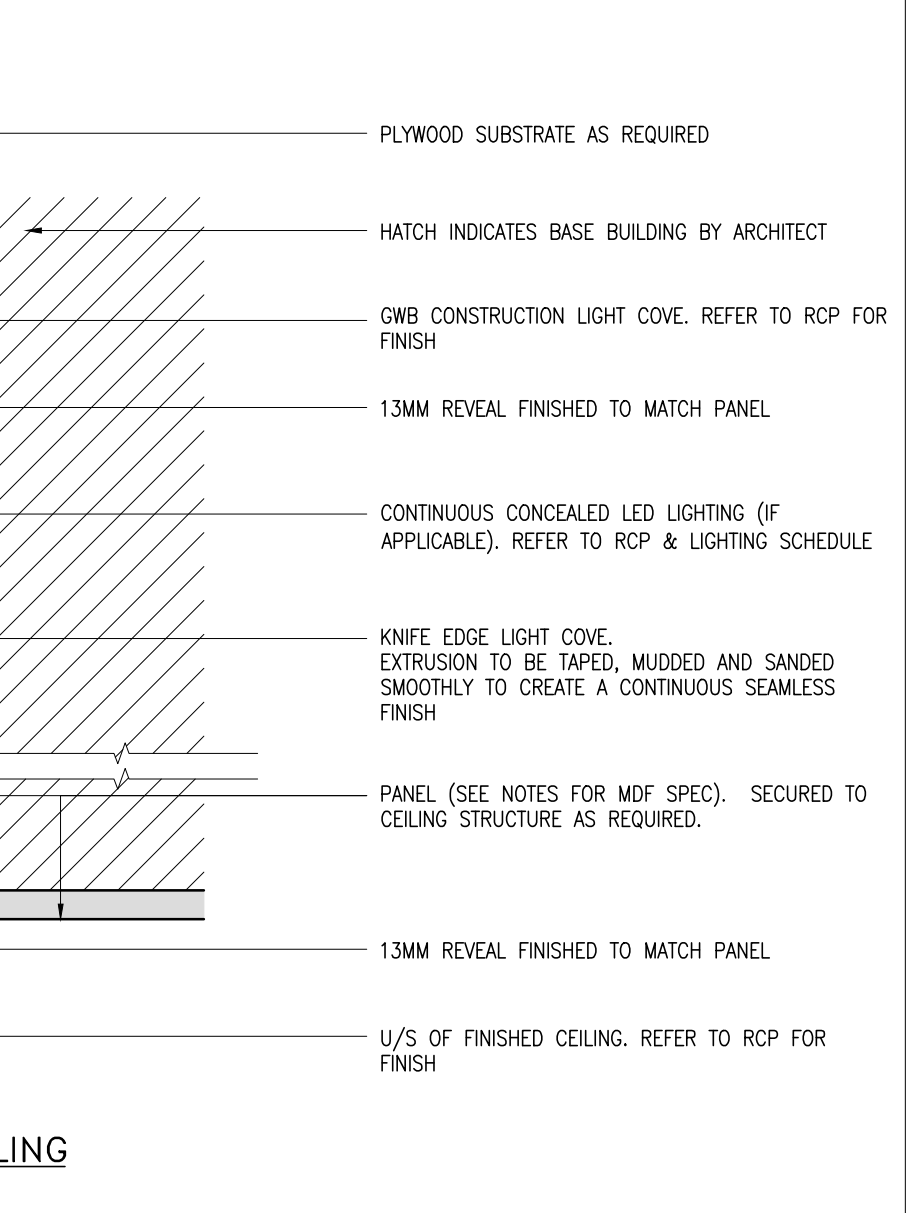
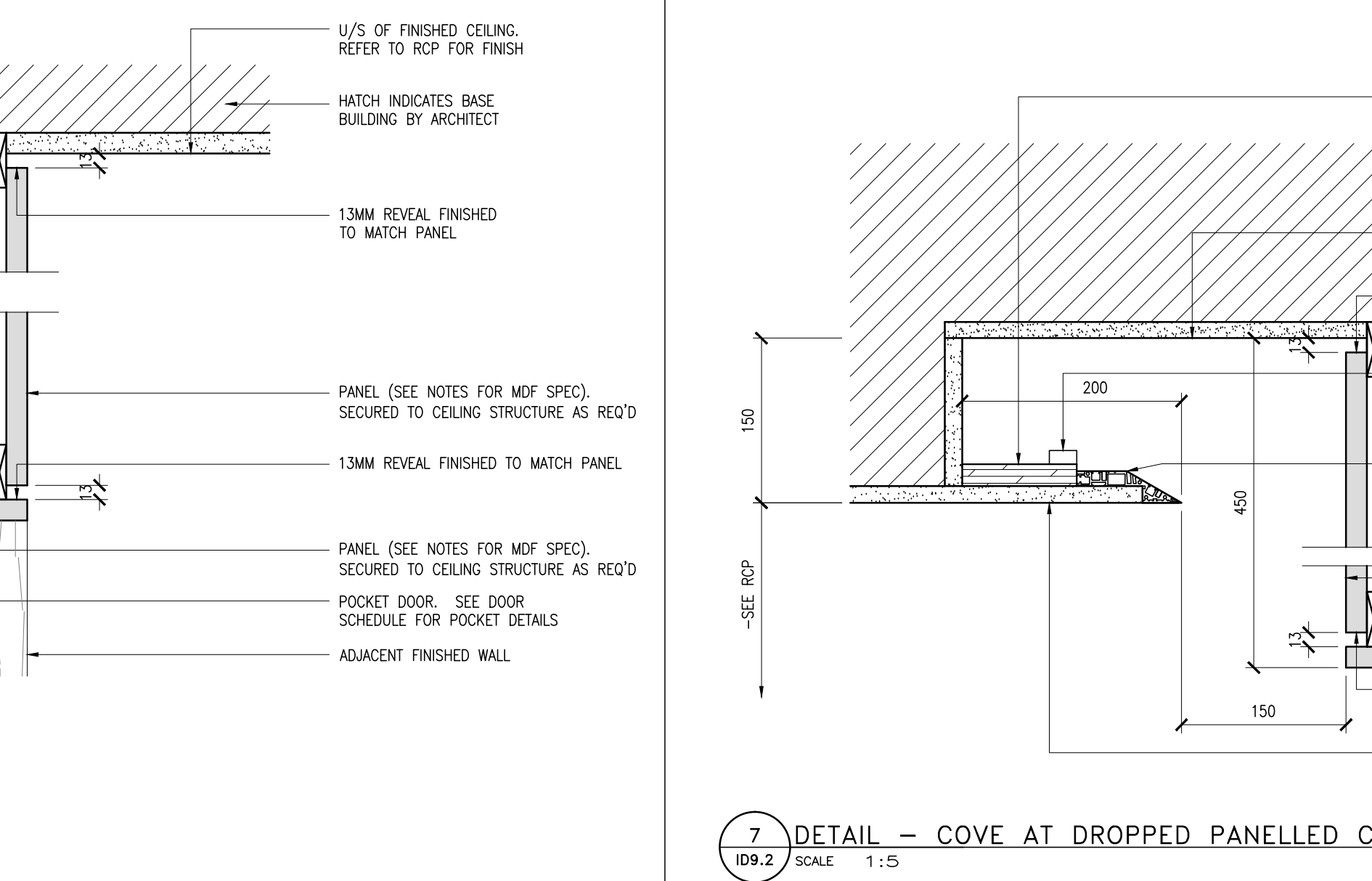
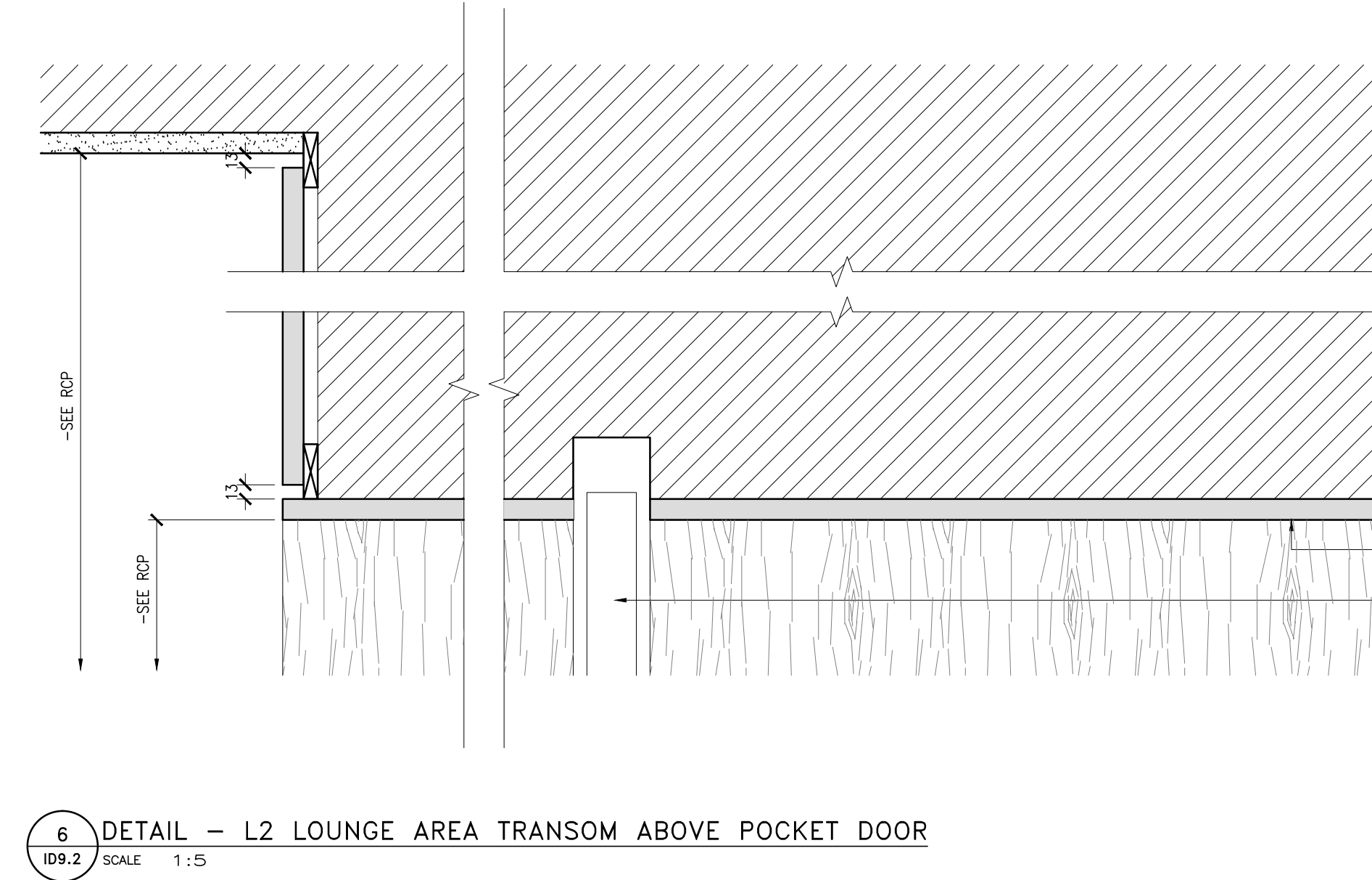
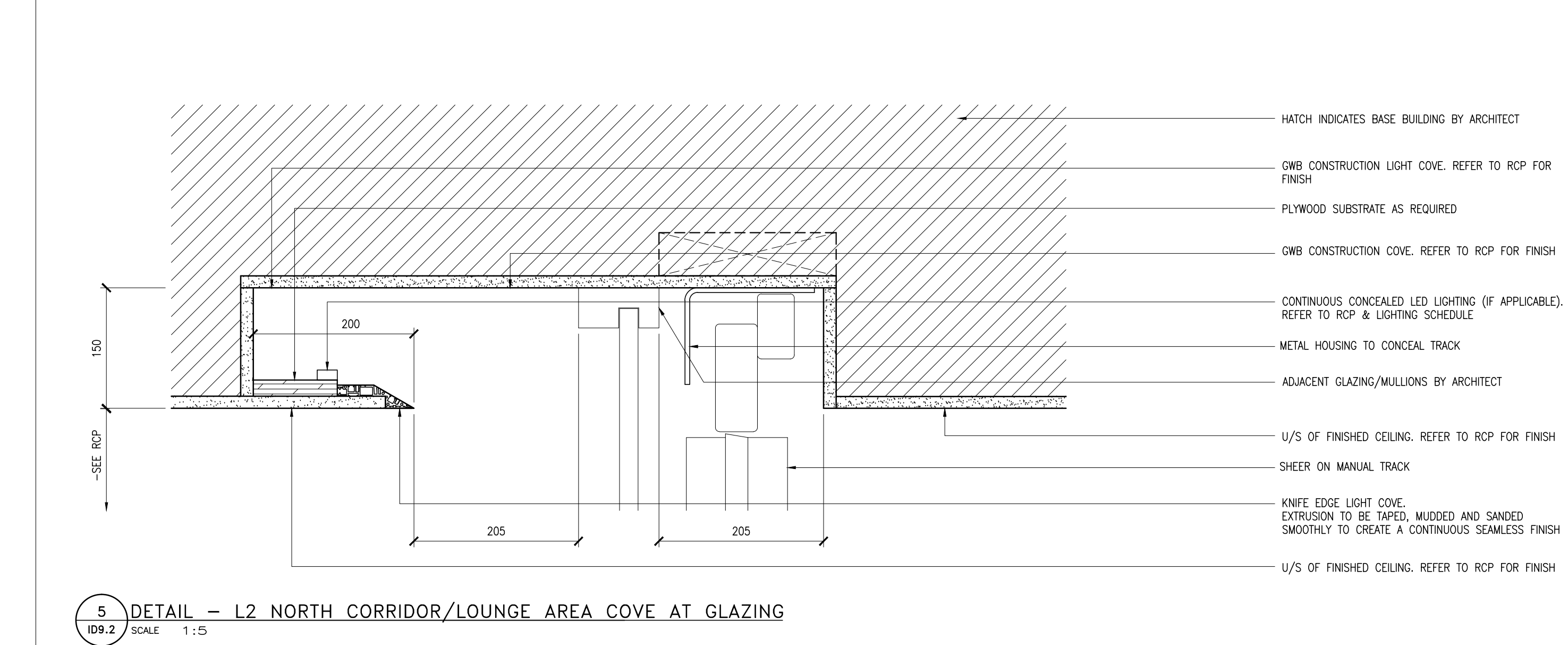
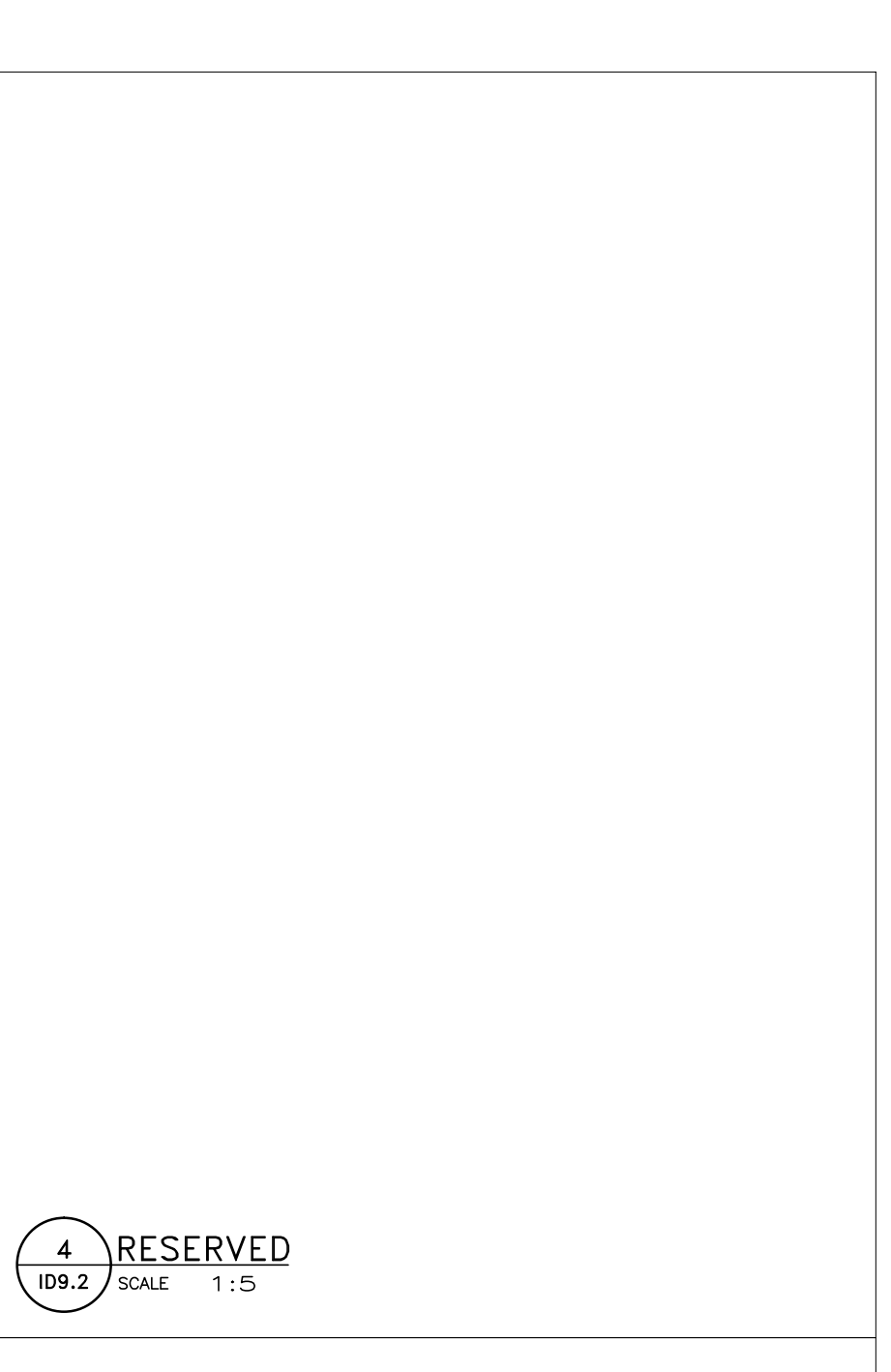
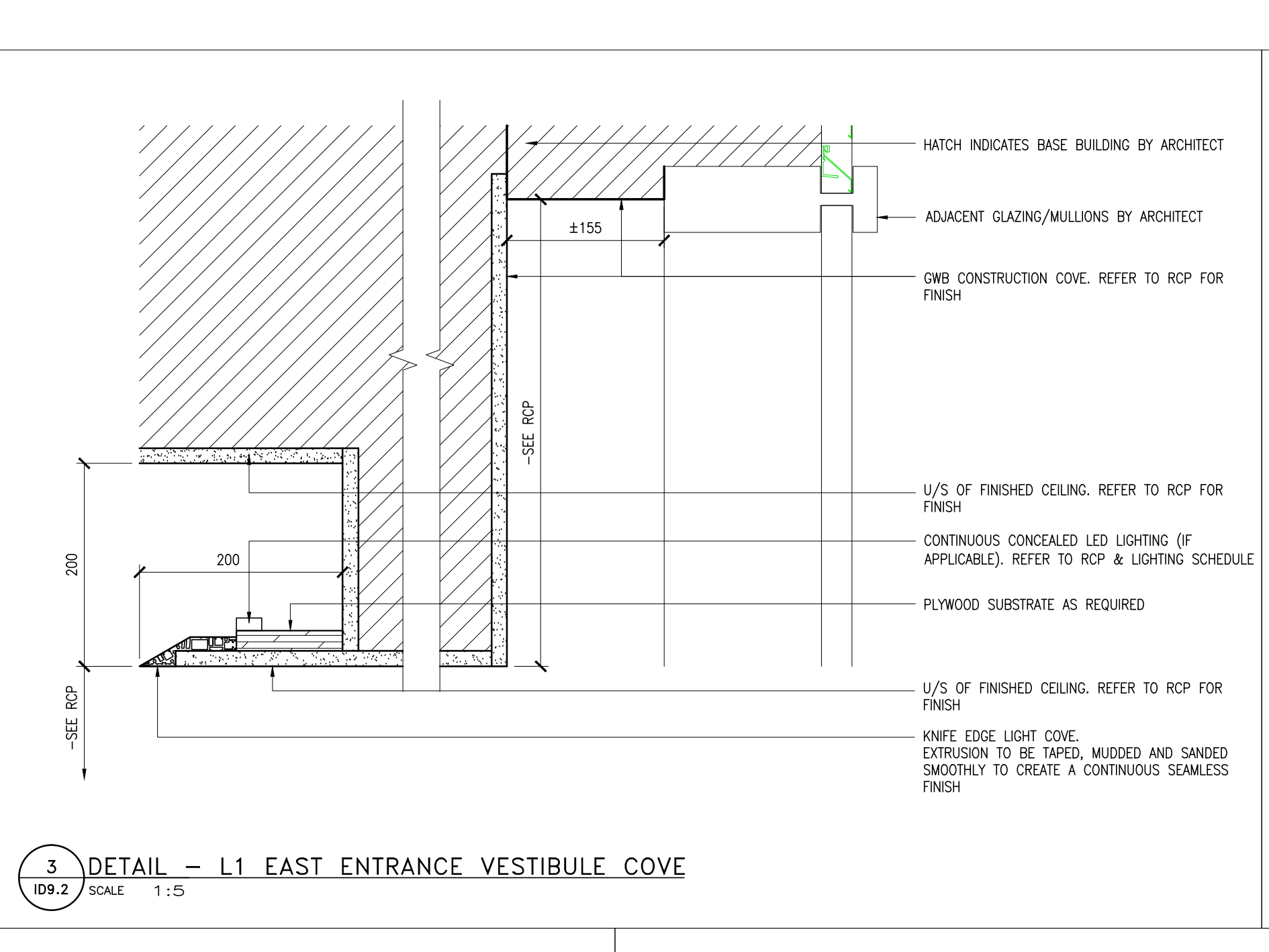
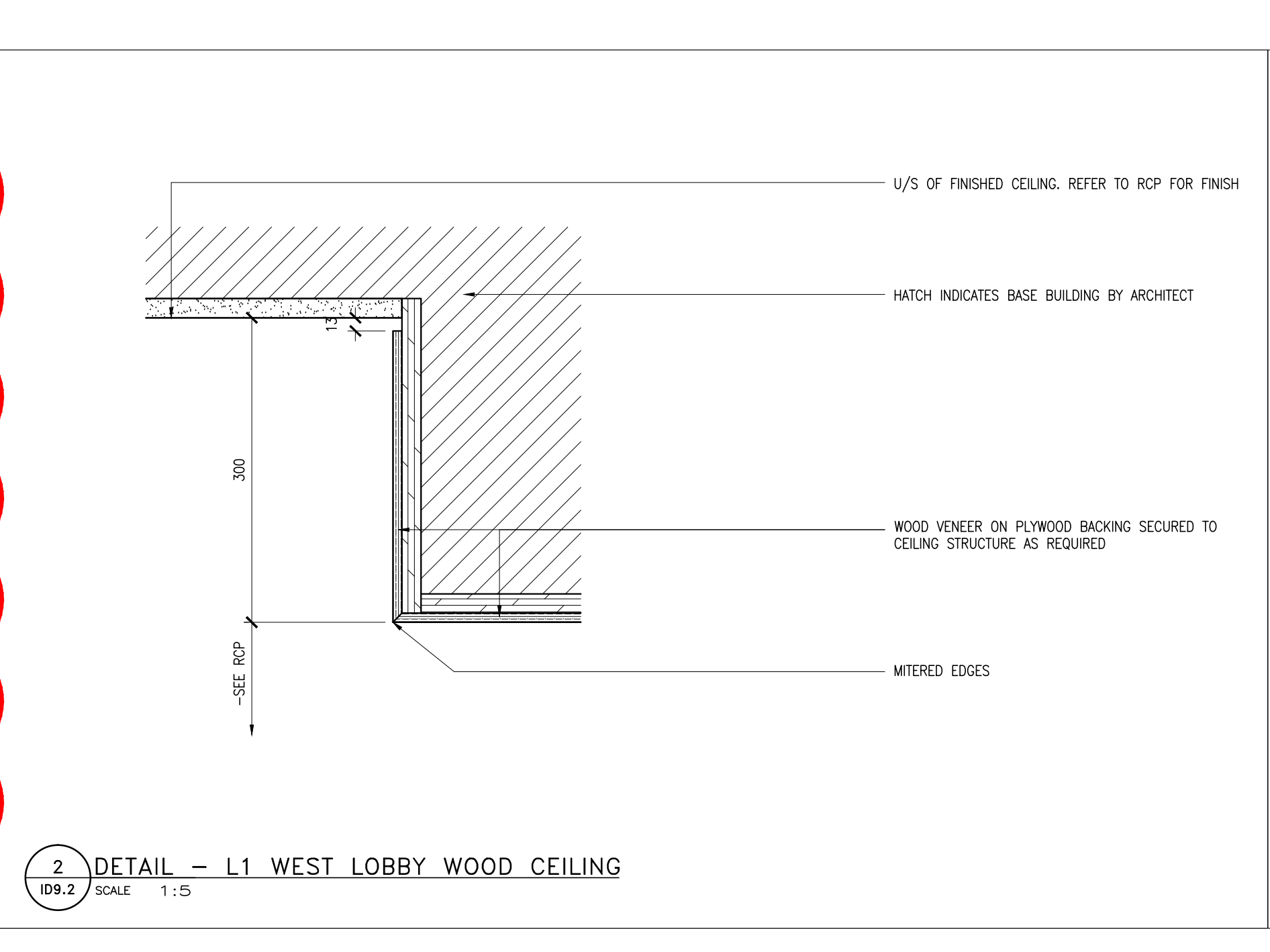
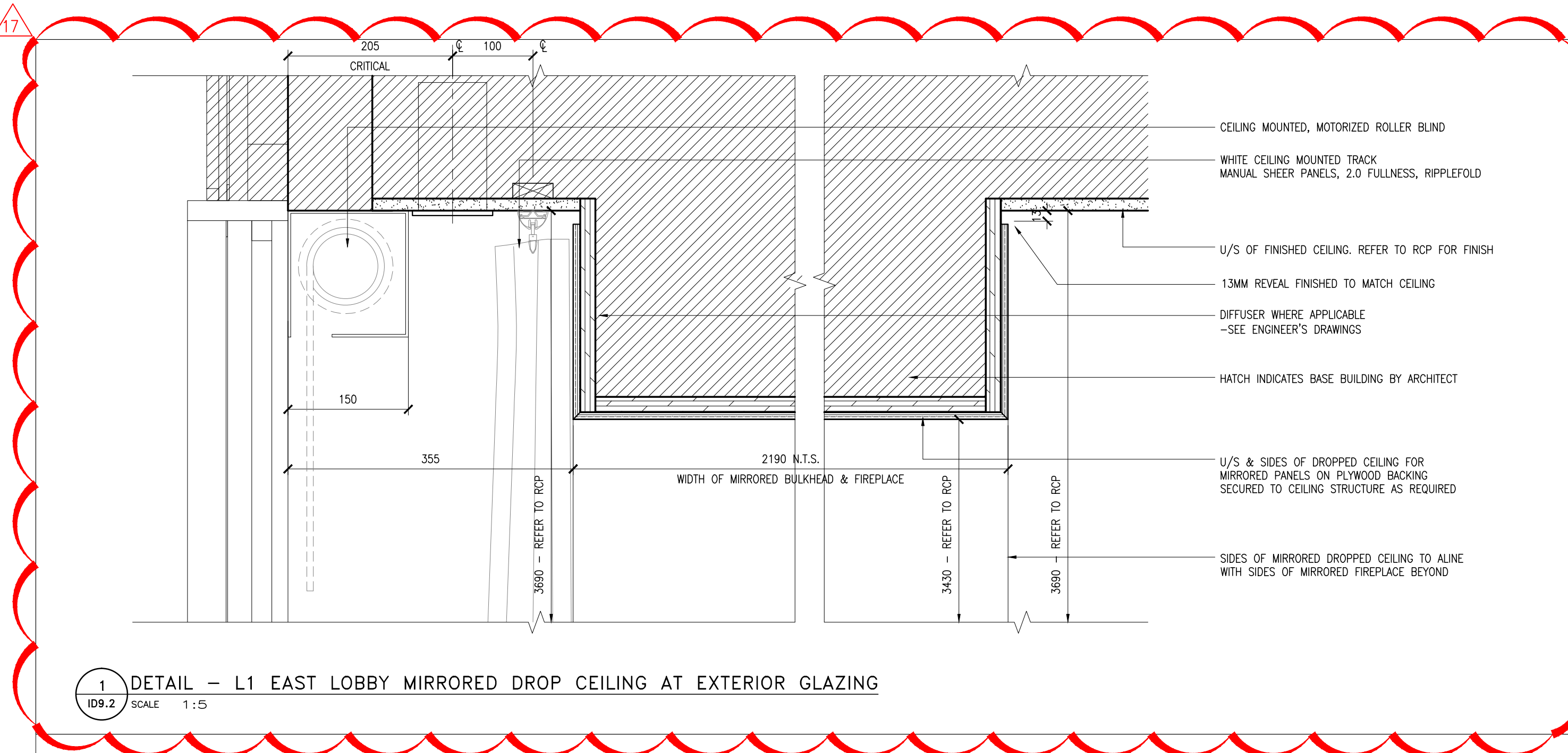

Hines TRIDEL

AQUAVISTA
AT BAYSIDE TORONTO
1 EDgewater Drive, Toronto Ontario

IBY DESIGN

TYPICAL CEILING DETAILS

Our Project Number: 1400B
Designed By: DANIEL VIV-SO
Drawing Number: DAN-VV-SO-BP

ID9.2